

EXAMPLE PLAN SHEET IS NOT TO SCALE

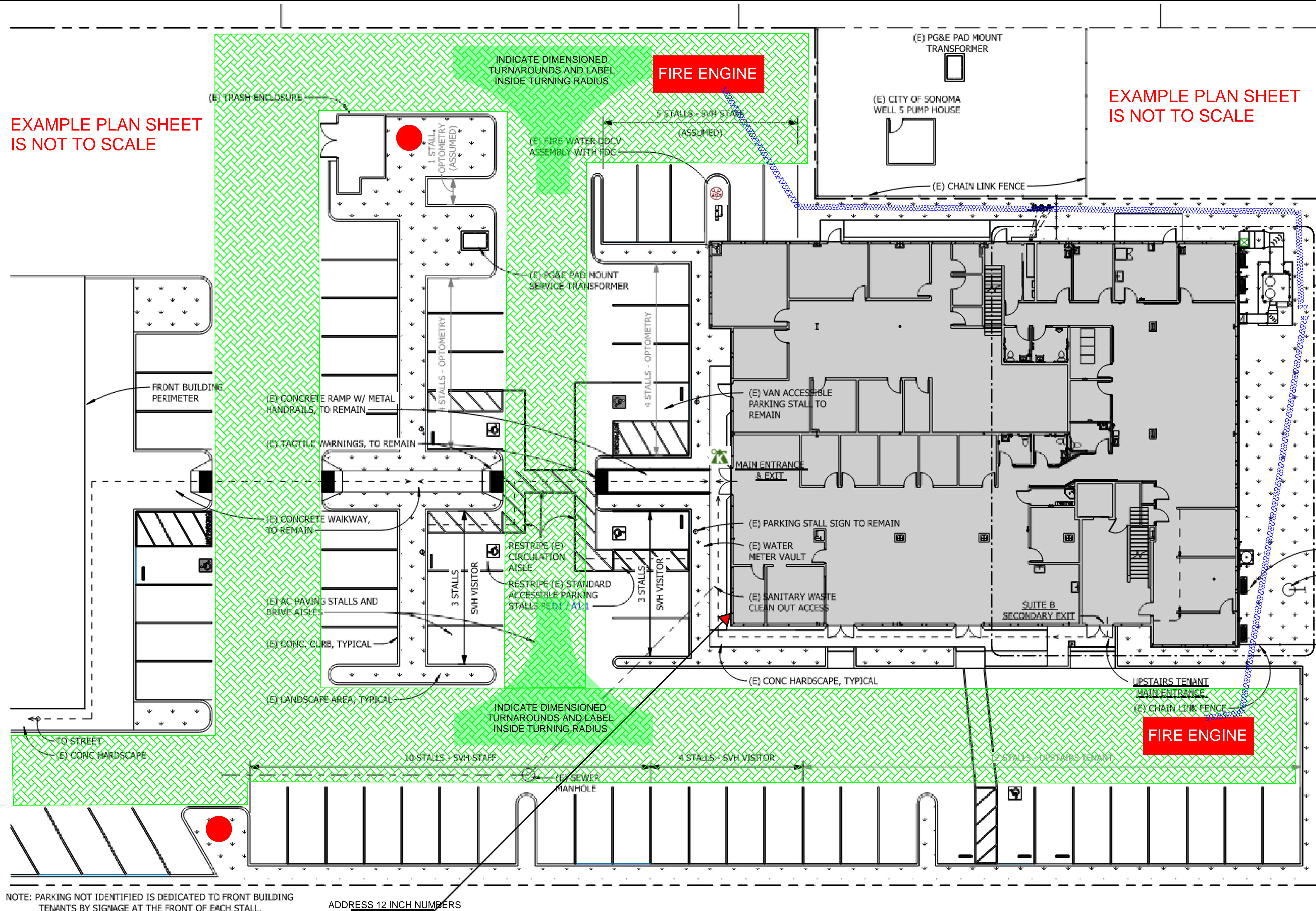

NOTE: PARKING NOT IDENTIFIED IS DEDICATED TO FRONT BUILDING TENANTS BY SIGNAGE AT THE FRONT OF EACH STALL.

ADDRESS 12 INCH NUMBERS

15000

2 PRIMARY SITE PLAN
A1.1 1/16" = 1'-0"



PROJECT INFORMATION:

PROJECT DESCRIPTION: NEW COMMERCIAL CONSTRUCTION
 SQUARE FOOTAGE: 10,874
 OCCUPANCY: B/A2
 STORIES: 2
 CONSTRUCTION TYPE: TYPE 3
 FIRE SPRINKLERS: DESCRIBE
 FIRE ALARM SYSTEM: DESCRIBE
 OTHER FIRE SYSTEMS: DESCRIBE

PROJECT CONTACTS:

OWNER / PROJECT ADDRESS:

ARCHITECT:

LANDSCAPE ARCHITECT:

CIVIL ENGINEER:

TOPOGRAPHIC SURVEY:

THIS PLAN SHEET IS REQUIRED FOR NEW DEVELOPMENT, REMODELS, LARGE COMMERCIAL TENANT IMPROVEMENTS, AND CHANGE OF OCCUPANCIES IN EXISTING BUILDINGS.

CODE COMPLIANCE:

CURRENT ADDITION [ADD YEAR] BUILDING STANDARDS INCLUSIVE OF THE CALIFORNIA FIRE CODE WITH LOCAL AMENDMENTS, CODES AND ORDINANCES, AND SVFD STANDARDS.

FIRE HYDRANT VICINITY MAP:

HYDRANT MUST BE WITHIN 150' OF BUILDING ENVELOPE & 50 FEET FROM FIRE DEPARTMENT CONNECTION

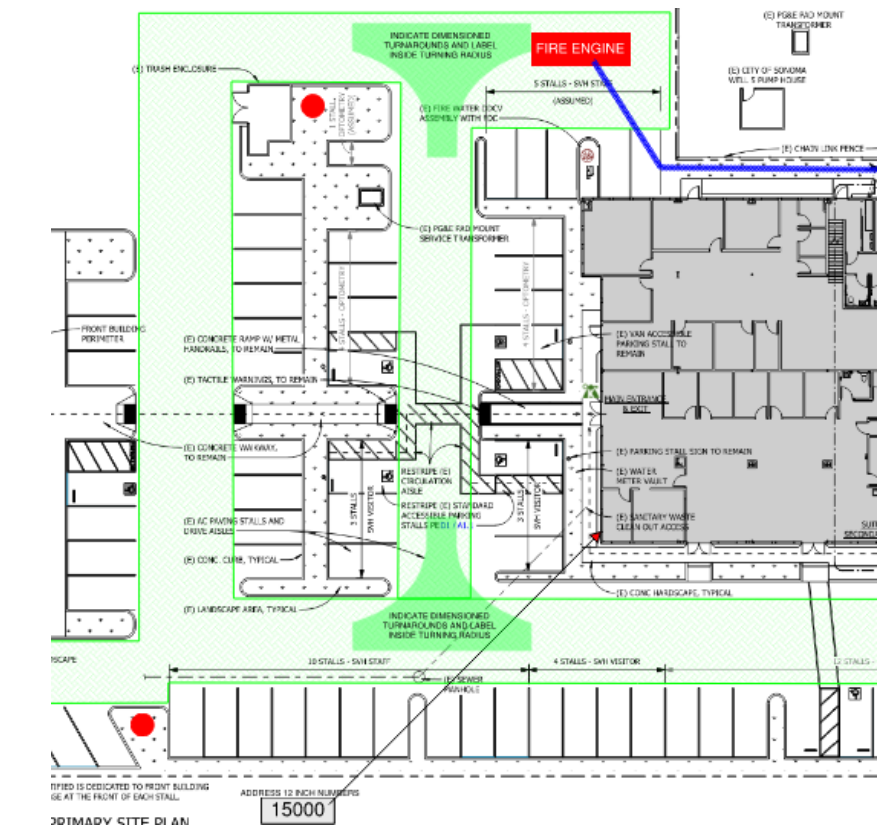

DISTRIBUTION / REVISIONS		
No.	Date	Revision

SAMPLE SET

FIRE DEPARTMENT SITE ACCESS PLAN
CITY OF SONOMA
COMMERCIAL PROJECT

FIRE DEPARTMENT NOTES:

Label Gas / Electric Utility - Utility identification. Gas shutoff valves, electric meters, service switches and other utility equipment shall be clearly and legibly marked to identify the unit or space that it serves. Identification shall be made in an approved manner, readily visible and shall be maintained. [CFC 2022 509.1.1] See standard and guideline www.sonomavalleyfire.org

Trash Enclosure:
 1. Dumpsters and containers with an individual capacity of 1.5 cubic yards [40.5 cubic feet (1.15 m³)] or more shall not be stored in buildings or placed within 5 feet (1524 mm) of combustible walls, openings or combustible roof eave lines. [CFC 2022 304.3.3]
 Exceptions:
 1. Dumpsters or containers in areas protected by an approved automatic sprinkler system installed throughout in accordance with Section 903.3.1.1, 903.3.1.2 or 903.3.1.3.
 2. Storage in a structure shall not be prohibited where the structure is of Type I or IIA construction, located not less than 10 feet (3048 mm) from other buildings and used exclusively for dumpster or container storage.

Fire Alarm System - (Sprinkler Monitoring Dedicated Function)
 1. New and Existing Sprinkler systems require electronic monitoring for tamper / waterflow and will require testing prior to final. Annual alarm system inspection certification will be required at time of final.

Posted address numbers shall be those assigned by the City of Sonoma. Buildings shall have approved address/suite numbers that are plainly legible and visible from the street fronting the property. Numbers for other than one- and two-family dwellings shall be a minimum of 12 inches high with a minimum stroke width of 1 inch. Suite numbers for other than one- and two-family dwellings shall be a minimum of 6 inches high and 0.5 inches stroke. The back door of each tenant space shall have the numerical address and store name on or above the door. [CFC 2022 - 505 As Amended]

Complex directory. Where two or more buildings cannot be viewed from the public way or when determined by the fire code official, an approved illuminated complex directory, monument, pole, or other approved sign or means shall be used to identify the structures at the main entrances to the property. The complex directory, monument, pole, or other approved sign or means shall comply with the requirements of the City's sign regulations contained in Title 18 of the Sonoma Municipal Code.

Fire Extinguishers- Size and distribution of fire extinguishers shall be based on the hazard(s) present. During construction, provide a minimum 2A fire extinguisher on each floor of structures under construction.

Following completion a 2A10B:C extinguisher(s) or other that meets the conditions of CFC 906, shall be provided on each level for a maximum of 3000 square feet of floor area or maximum of 75 feet of travel distance. [CFC 2022 906] - Must be visible, accessible and unobstructed.

Class K fire extinguisher will be required in kitchen areas if present. Per CFC 906. Additional fire extinguishers may be required based on hazard.

SITE PLAN LEGEND:

- EMERGENCY VEHICLE ACCESS REQUIRED IN COMPLIANCE WITH APPENDIX D OF THE CALIFORNIA FIRE CODE. 20 FEET WIDE OR 28 FEET WIDE IF LADDER TRUCK ACCESS IS REQUIRED (VERTICAL CLEARANCE 13'6") RATED 75,000 POUNDS. REQUIRED INSIDE TURNING RADIUS 35 DEG.
- HOSE PULL FROM REQUIRED FIRE DEPARTMENT ACCESS ROAD WITHIN 150 FEET OF ALL STRUCTURES CFC 503
- KNOX KEY BOX OR GATE SWITCH AS REQUIRED BY CFC CHAPTER 506 FOR ORDERING & MOUNTING INSTRUCTIONS VISIT SONOMAVALLEYFIRE.ORG
- FIRE HYDRANT - CFC 507 - CITY OF SONOMA REQUIRED EVERY 150 FEET AND WITHIN 50 FEET OF FIRE DEPARTMENT CONNECTIONS
- FIRE HYDRANT - CFC 507 - CITY OF SONOMA REQUIRED EVERY 150 FEET AND WITHIN 50 FEET OF FIRE DEPARTMENT CONNECTIONS

DATE:
SCALE:
PROJECT:
DRAWN BY:

